

HAFENKRÄNE  
HARBOR CRAN  
GRUES PORTUAIRES

HAVENKRANEN  
GRÚAS PARA PUERTOS  
GRU DA PORTO

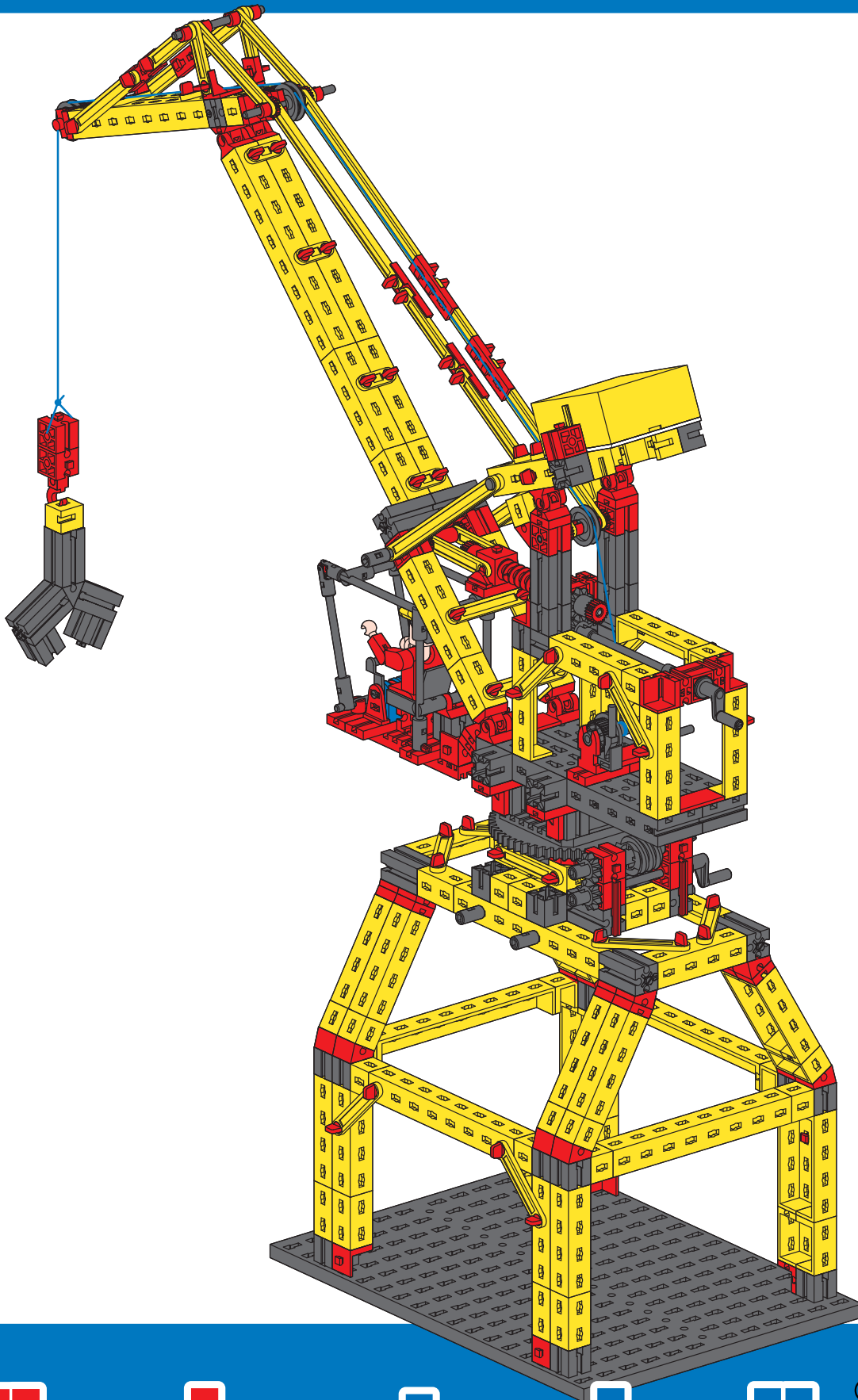

**fischertechnik**®







Montagehilfen und Hinweise  
 Assembly aids and instructions  
 Aides de montage et instructions

Montagehulpmiddelen en aanwijzingen  
 Ayudas de montaje e instrucciones  
 Aiuto e indicazione di montaggio

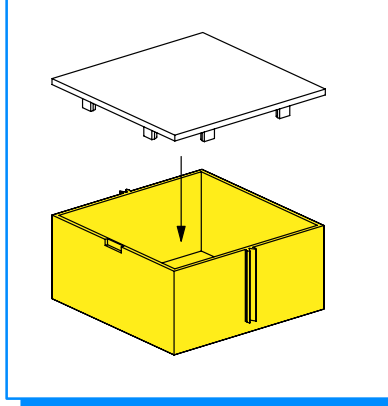
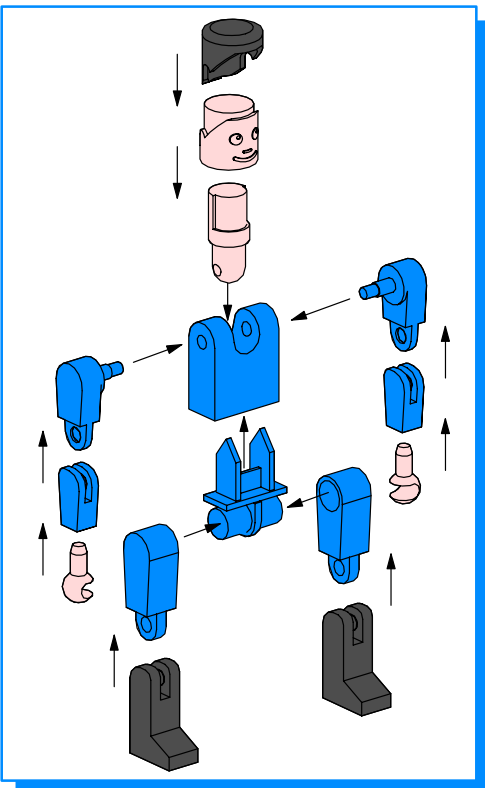
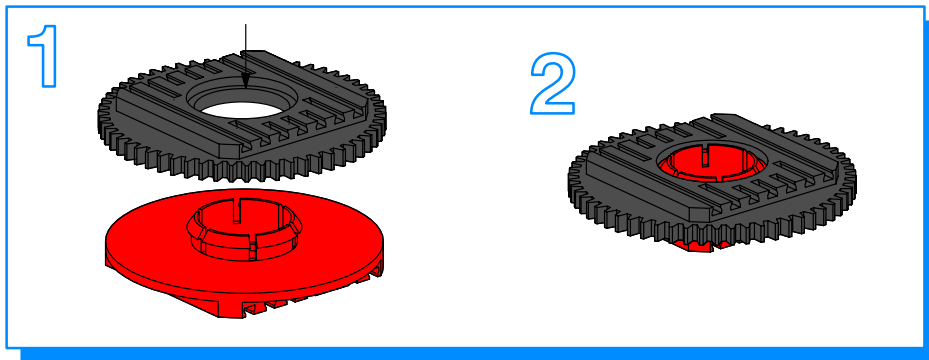
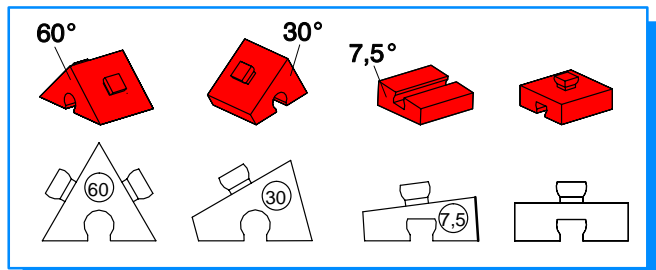
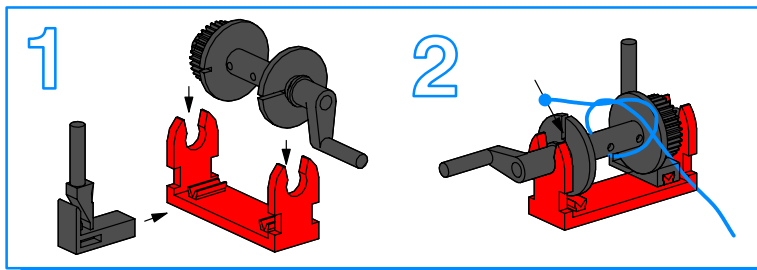
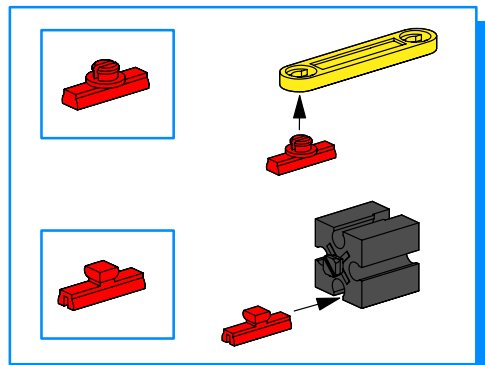
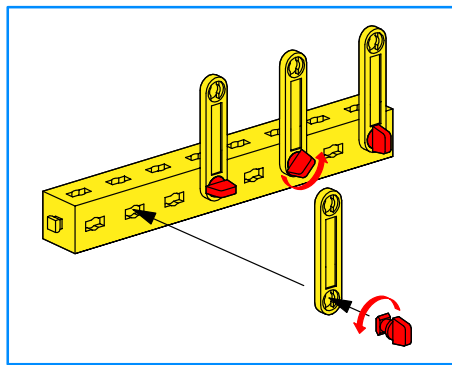
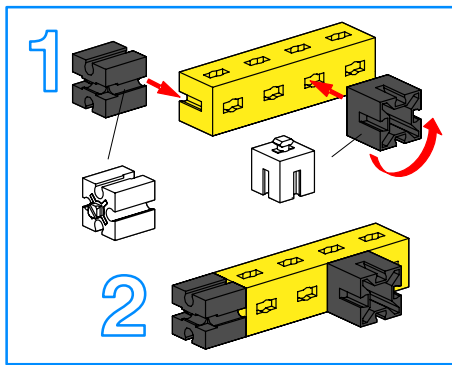
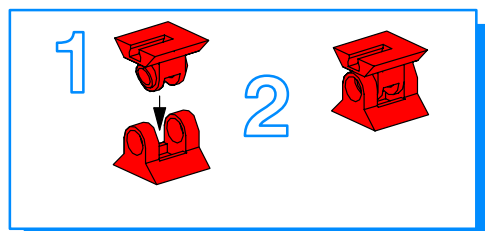
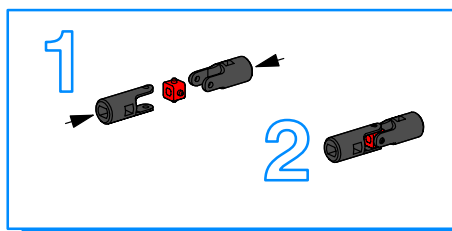
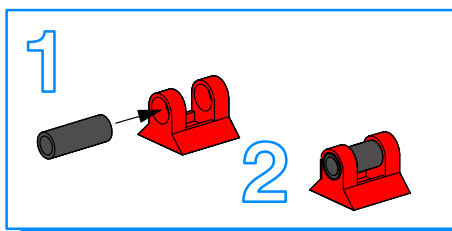

Behälter für Gegengewicht kann z.B. mit Steinen, Nägeln oder Schrauben befüllt werden.  
 The counterbalance container can be filled with stones, nails, screws, etc.  
 La caisse à contrepoids peut être remplie avec par exemple des pierres, des clous ou des vis.  
 Container voor tegengewicht kan bijv. met stenen, draadnagels of schroeven worden gevuld.  
 El recipiente del contrapeso puede rellenarse p.ej. con piedras, clavos o tornillos.  
 Recipiente per contrappeso riempibile per es. con sassi, chiodi o viti.

Alle Einzelteile, insbesondere bewegliche Teile sind falls notwendig zu warten und zu reinigen.

Alle onderdelen, vooral de bewegende delen, kunnen, indien noodzakelijk, onderhouden en gereinigd worden.

All components, especially moving parts, should be maintained and cleaned as necessary.

Es necesario limpiar y mantener en buen estado todas las diferentes piezas - especialmente las piezas móviles.

Toutes les pièces détachées et en particulier les pièces mobiles, sont, si nécessaire, à entretenir et à nettoyer.

Provvedere all'occorrenza alla manutenzione e alla pulizia di tutti i particolari, specialmente le parti mobili.

Verladekran  
Loading crane  
Grue de manutention

Laadkraan  
Grúa de descarga  
Gru da carico

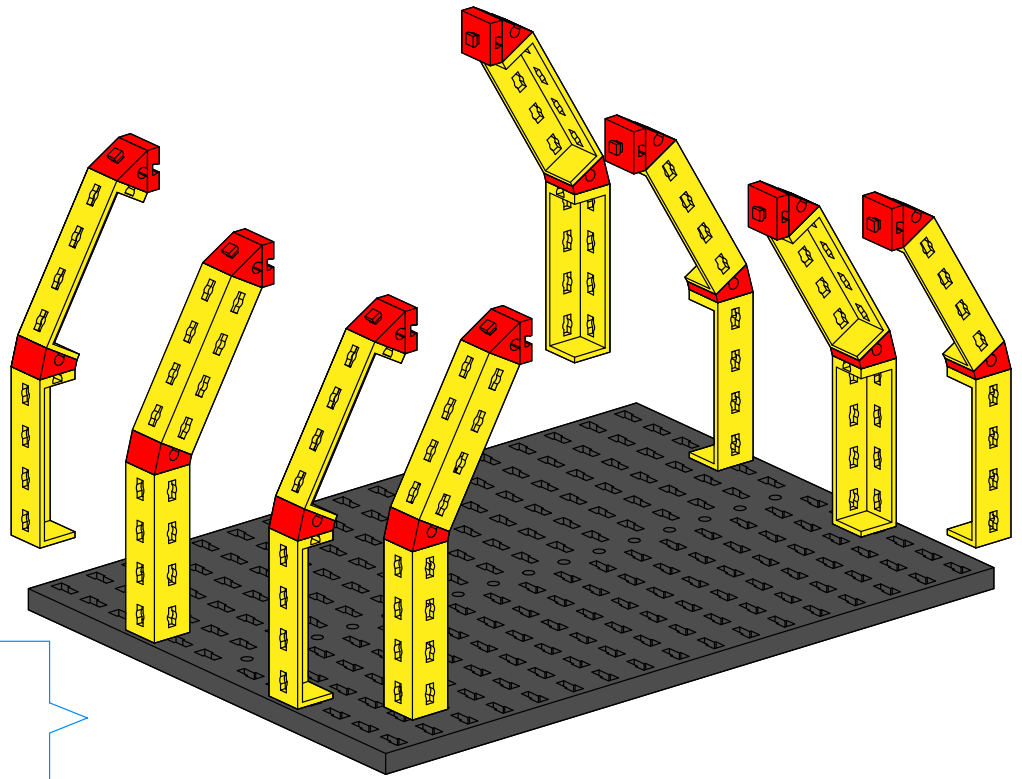

1

1x

